



## OZ06J Eco-Flex (110Lm/w)

### Basic Information

Product Name	Tri-Proof Light
Model	OZ06J
Protection Level	Class II , IK08
Ingress Protection	IP 65
Usage	Intensive, Dusty, Rain

### Physical Parameter

Lamp Base Material	ABS
Lamp Cover Material	Polycarbonate
Working Temperature	20 ~ 40
Installation	Ceiling, Suspended
Led Strips	<u>S</u> =Single, <u>D</u> = Double

### Optical Parameter

Input Voltage	220-240 Volt
Color Temperature	3000K, 4000K, 6000K
Life Span	50,000 hrs.
Warranty	3 Years

### Additional Features

Sensor	(S) Optional
Emergency	(EM) Optional
Dimmable	(D) Optional

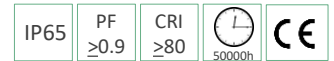

Item Ref	Power	Source	Lumen	Light Efficiency	P.F	CRI	Product Size
OZ06J069 <u>S</u> -1	9 watt	SMD2835	990Lm	110 lm/w	> 0.5	> 80	550*58*58
OZ06J0618 <u>D</u> -1	18 watt	SMD2835	1980Lm	110 lm/w	> 0.5	> 80	550*78*58
OZ06J1218 <u>S</u> -1	18 watt	SMD2835	1980Lm	110 lm/w	> 0.9	> 80	1150*58*58
OZ06J1236 <u>D</u> -1	36 watt	SMD2835	3960Lm	110 lm/w	> 0.9	> 80	1150*78*58
OZ06J1524 <u>S</u> -1	24 watt	SMD2835	2640Lm	110 lm/w	> 0.9	> 80	1450*58*58
OZ06J1548 <u>D</u> -1	48 watt	SMD2835	5280Lm	110 lm/w	> 0.9	> 80	1450*78*58

## OZ06J (110Lm/w)

### Product Information:

- Dust proof, Weather proof & Corrosion proof.
- Durable outer casing / Cover made of high impact Polycarbonate material.
- Indoor or outdoor installation in the garages, cellars , industrial complex, Parking lots
- Available with high quality Led Strip & driver.
- High hardness, smooth surface, not easy to distort,
- Excellent heat dissipation and complete source of light control of light failure
- Cover: PC material, high transparency, no dazzling, impact resistance, corrosion resistance.

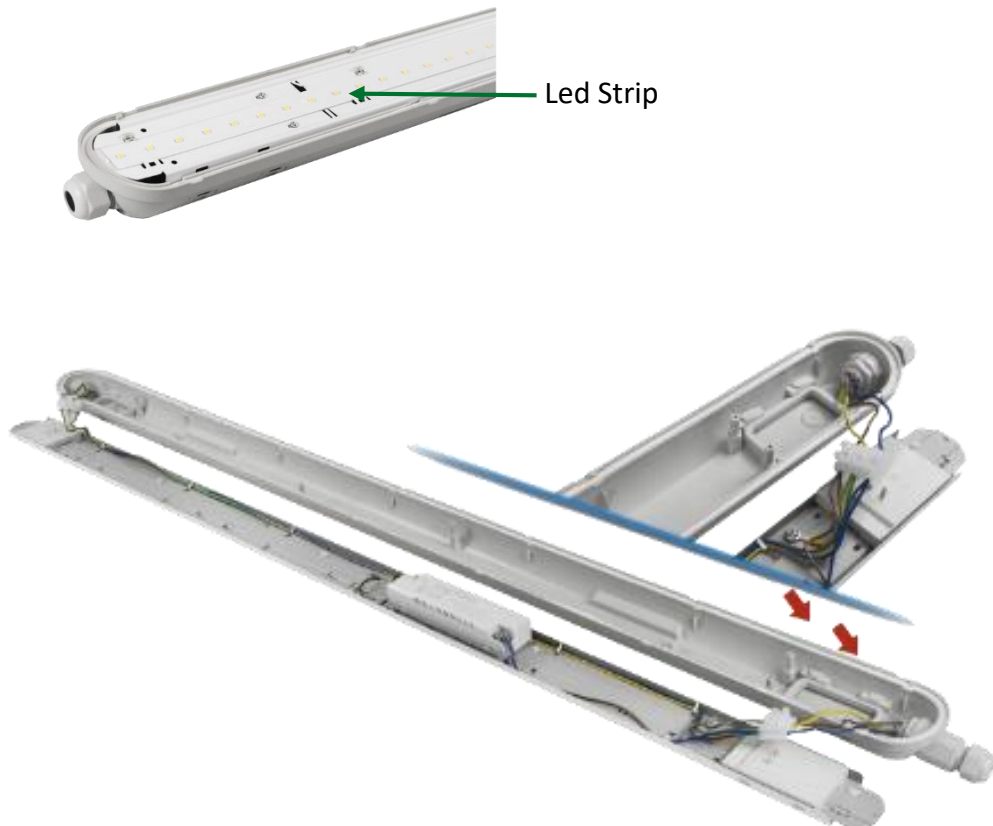



- Led Emergency Converter, that can transform standard Led fitting into emergency Led Fitting.
- Nickle Cadmium Battery.
- Suitable for led fitting with external driver.
- Accessory: test switch & charge indicator



## OZHD011SR



On/off control



Daylight sensor



Detection area



Warranty 5 years



Hold-time

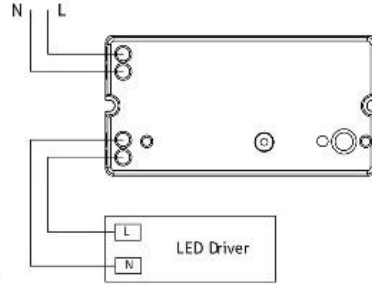

### Mechanical structure(mm)

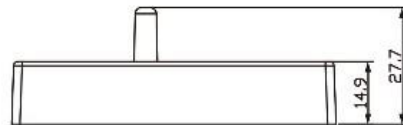
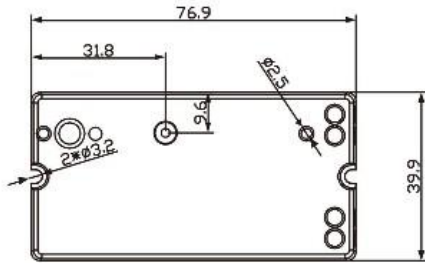

### Detection coverage

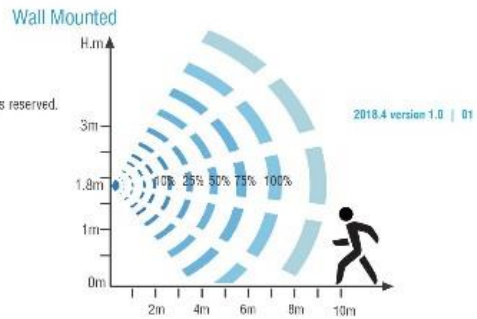
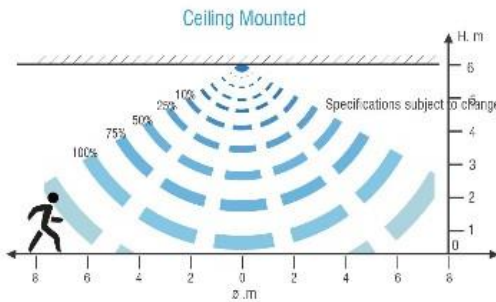

### Application Function Demo-On/off control



With sufficient daylight, even when motion detected, light remains OFF.



With insufficient daylight, when motion detected, light ON.

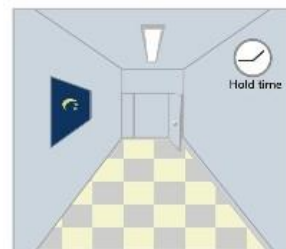

After the last detection and the present hold time elapsed, light OFF.